



25 Blenheim Road, Slough, SL3 7NL
£795,000

 **HORLER**

25 Blenheim Road, Slough, SL3 7NL

*****CATHCMENT AREA FOR CASTLEVIEW SCHOOL AND LANGLEY GRAMMER*** *****HUGE SCOPE TO EXTEND (STPP)*******

A charming three-bedroom detached home situated on Blenheim Road in Slough, offering spacious and well-presented accommodation throughout. The property features an open-plan living and dining area leading into a bright sun room, creating an ideal space for family living and entertaining. Benefits include driveway parking, a garage, and a large rear garden with mature shrubs. Conveniently located close to local amenities, shops, and excellent transport links, this property is perfectly suited for families and commuters alike.



Property Summary

This delightful three-bedroom detached home located on the charming Blenheim Road in Slough, offers a perfect blend of comfort and convenience. As you approach the property, you will appreciate the practicality of driveway parking and a garage, providing ample space for your vehicles and additional storage.

Upon entering, you are welcomed into an inviting open-plan living room and dining area, which seamlessly flows into a bright sun room. This layout is ideal for both entertaining guests and enjoying family time, allowing natural light to flood the space and create a warm atmosphere.

The property boasts a large rear garden, adorned with mature shrubs, offering a tranquil retreat for outdoor relaxation or gardening enthusiasts. This expansive outdoor space is perfect for children to play, hosting summer barbecues, or simply unwinding in the fresh air.

Situated in a vibrant community, this home is conveniently located near local amenities, shops, and excellent transport links, making it easy to access everything you need for daily life. Whether you are commuting to work or exploring the local area, you will find that this location provides both ease and accessibility.

In summary, this detached house on Blenheim Road is an ideal choice for families or individuals seeking a comfortable home with a lovely garden and convenient access to local facilities. Do not miss the opportunity to make this charming property your own.

Legal note:

****Although these particulars are thought to be materially correct, their accuracy cannot be guaranteed and they do not form part of any contract.****





Total Approximate Floor Area
1292 Square feet
120 Square metres

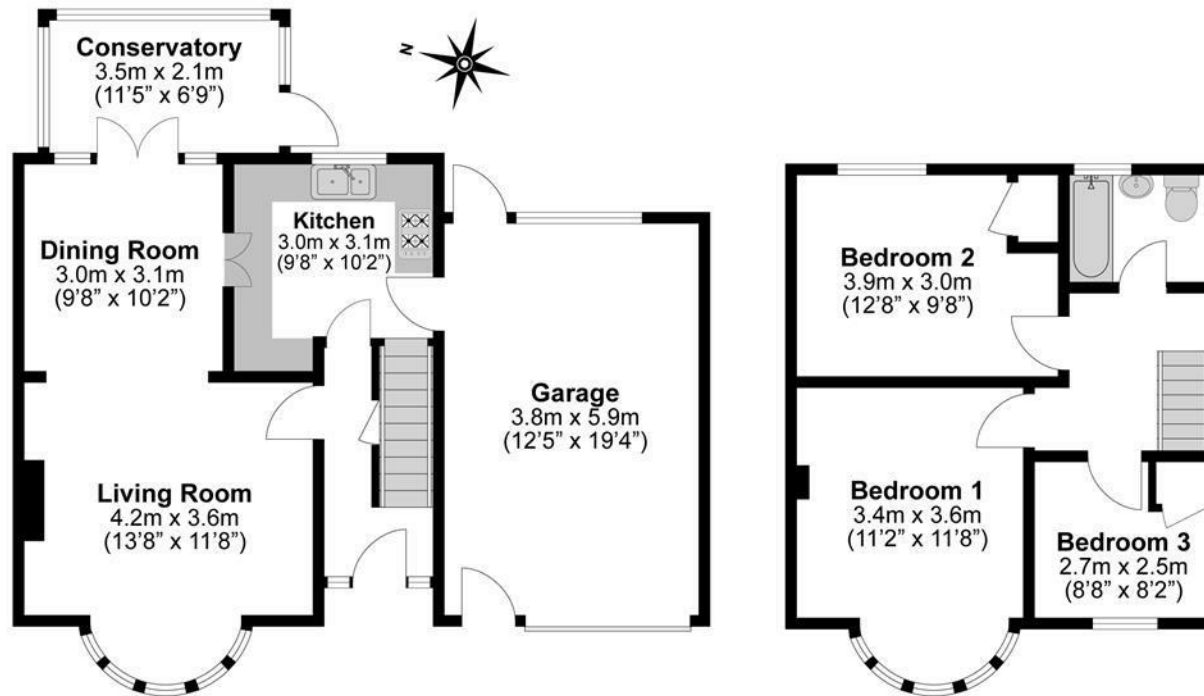

**Illustrations are for identification purposes only,
measurements are approximate, not to scale.**